



**AUTONAUTIC**  
the compass specialist

# PRODUCT DATASHEET

COMPASS

**C8-0027**

**BRACKET-MOUNT**

---

SKU C8-0027

Bracket Mount Wheelmark/SOLAS compass

## C8-0027 BRACKET-MOUNT POWER & WORKBOAT



### ROOFLINE INSTALLATION

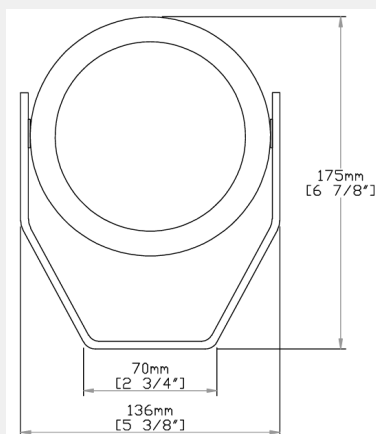

## OVERVIEW

The C8-0027 bracket mount compass is one of our most popular and versatile workboat compasses. The compass is based on a vertical bulkhead style of compass so can be viewed from a wider range of angles.

In particular, this feature allows the compass to be mounted above eye line and thus the compass can be mounted from the wheel house deck head or roofline. This can be advantage when space is at a premium or when magnetic interference precludes mounting a magnetic compass on the console.

The 100mm conical card provides good clarity at long distance making this compass suitable for a wide range of wheel house configurations on small to medium sized workboats.

## FEATURES

100mm conical card

5° graduation

Deck shoe mounting

12/24 V lighting

Individual MED/SOLAS certificate included

100% Repairable

Exclusive 5 year warranty

## APPROVALS

Directive 2014/90/EC on marine equipment

ISO 25862:2019

ISO 9001 certified management system

**ISO  
25862**

Click [here](#) to see EC  
Type Examination  
(Module B) Certificate

Member of CISQ Federation

**CERTIFIED MANAGEMENT SYSTEM  
ISO 9001**

www.autonauticinstrumental.com  
info@autonauticinstrumental.com  
Agricultura 22, El Masnou (08320), Barcelona  
+34 93 540 99 49



[www.autonauticinstrumental.com](http://www.autonauticinstrumental.com)  
[info@autonauticinstrumental.com](mailto:info@autonauticinstrumental.com)

*The world's lead specialist company in magnetic compasses*